

# GEISSELE<sup>®</sup>

## AUTOMATICS

We Manufacture Confidence<sup>®</sup>

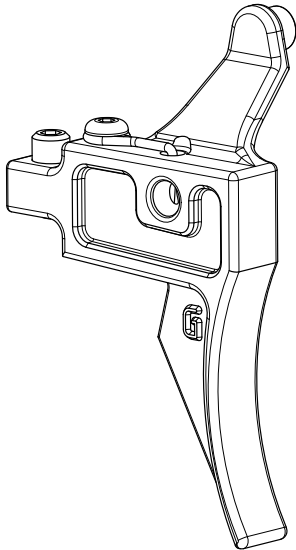

## LIGHTNING BOW<sup>™</sup>

FOR THE IWI TAVOR<sup>®</sup>

### Installation Instructions

#### READ THIS FIRST

Firearm safety is **YOUR** responsibility. You must memorize and put into practice the 4 Rules of Firearm Safety:

1. **ASSUME EVERY WEAPON IS LOADED.**
2. **KEEP YOUR FINGER OFF THE TRIGGER UNTIL YOU ARE READY TO SHOOT.**
3. **DO NOT LET THE MUZZLE POINT AT ANYTHING YOU ARE NOT WILLING TO DESTROY.**
4. **KNOW YOUR TARGET AND WHAT IS BEYOND.**

The Geissele Lightning Bow<sup>™</sup> is an advanced replacement trigger bow for the IWI Tavor<sup>®</sup> rifle. Made from nitrided alloy steel, the Lightning Bow's hybrid flat face/curved bow spreads the pressure from the trigger squeeze over a larger area, giving the shooter unprecedented trigger control.

The Lightning Bow also removes the inherent slack and looseness from the Tavor's long trigger bar. This tightens up the trigger pull and when combined with the Geissele Super Sabra trigger pack will give the Tavor the best trigger pull of any bullpup rifle.

*Geissele Automatics recommends installation by a certified gunsmith only*

#### INSTALLATION INSTRUCTIONS

1. Follow the IWI armorer instructions for removing the barrel assembly and the stock trigger bow. Also remove the trigger pack from the rifle.
2. Remove the retainer wire (**Item 2**) for the trigger spring from the Lightning Bow (**Item 1**).  
**WARNING:** The trigger pin will not push the retainer wire out of the way if an attempt is made to insert the trigger pin while the retainer wire is installed. The retainer wire **MUST** be removed before pin installation or removal and only installed once the trigger pin is in place.
3. Install the Lightning Bow being careful not to excessively bend the trigger bar when inserting the round boss into the bar.
4. Install the trigger pin and line up the groove in the trigger pin with the intersecting hole for the retainer wire.
5. Install the retainer wire using the 3-48 x1/4" (**Item 3**) screw to secure the retainer wire to the Lightning Bow.
6. At this time the Lightning Bow must be checked for rubbing in the housing slot. Push the trigger pin back and forth until the Lightning bow swings freely. It is recommended to push the pin to one side to get the trigger to rub, then push back the other way in small increments until the bow swings freely. The interference fit of the plastic housing to the trigger pin will hold the pin and bow in place.  
**NOTE:** *If the trigger will not swing freely, check for interference areas where the plastic receiver is touching the trigger. Areas to look for where rubbing may occur are listed on the attached drawing.*
7. Re-install the trigger pack.
8. The slack adjustment screw (**Item 4**) can now be turned in so that any slack present in the trigger bar can be removed. The polymer compound on the slack adjustment screw will keep the screw in place. Be careful dry firing the trigger without the bolt carrier in place.
9. After this process is complete, it is very important to check the safety for proper operation. If the safety can not be engaged, the adjustment screw has to be backed off slightly.
10. Once the slack is removed from the trigger, the rifle can now be re-assembled according to the IWI armorer instructions.
11. After re-assembly, recheck safety function and test fire the rifle using just two rounds in the magazine to verify proper function.

Thank You For Your Purchase.

Contact Geissele Automatics with any questions.

GEISSELE AUTOMATICS • 800 NORTH WALES RD • NORTH WALES, PA 19454

TEL: 610-272-2060 | FAX: 610-272-2069

E-MAIL: INFO@GEISSELE.COM | WEB: WWW.GEISSELE.COM

Parts List		
ITEM	QTY	DESCRIPTION
1	1	02-455 TRIGGER, LIGHTNING BOW
2	1	04-213 RETAINER WIRE, PIVOT PIN
3	1	3-48 X 1/4 CAP SCREW, BUTTON HEAD HEX KEY
4	1	8-32 X 3/8 SET SCREW, HEX HEAD

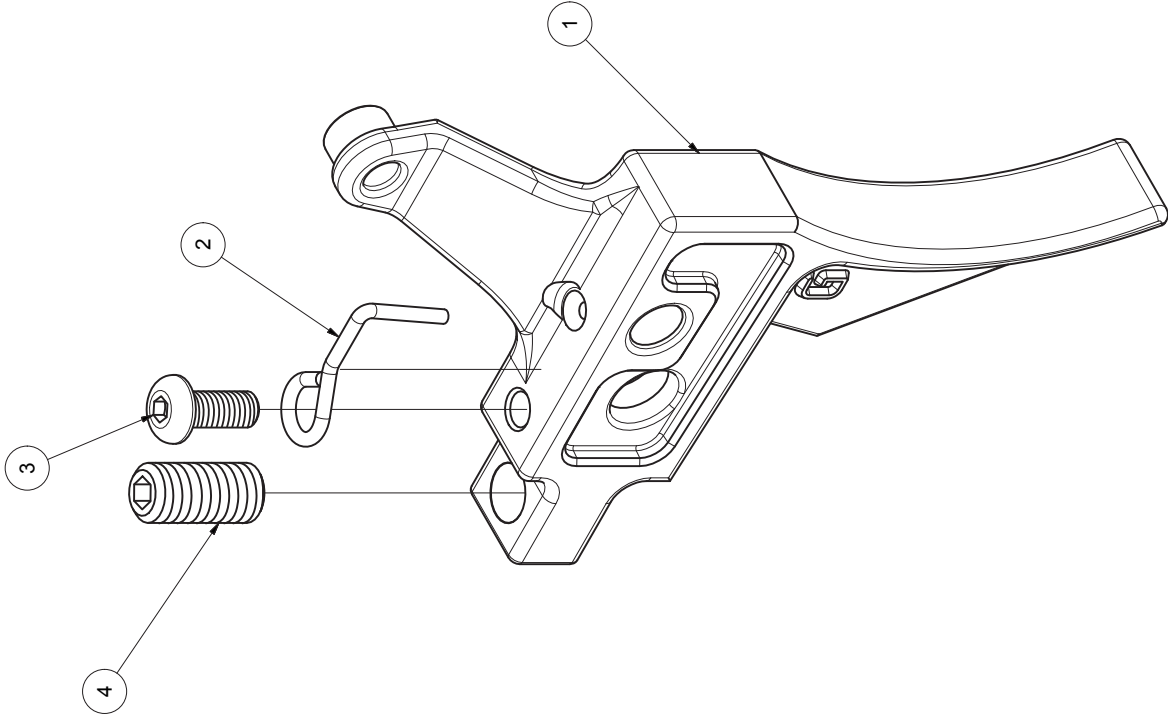

## AREAS TO LOOK FOR RUBBING

- A. The face of the trigger bar boss can rub on the inside of the receiver.
- B. The top edge of the rounded area near the trigger pin can rub here.
- C. The side of the rectangular slot where the bow of the triggers goes through.

*Relieve these areas of rubbing by shaving away plastic from the receiver with an exacto knife or dremel tool.*

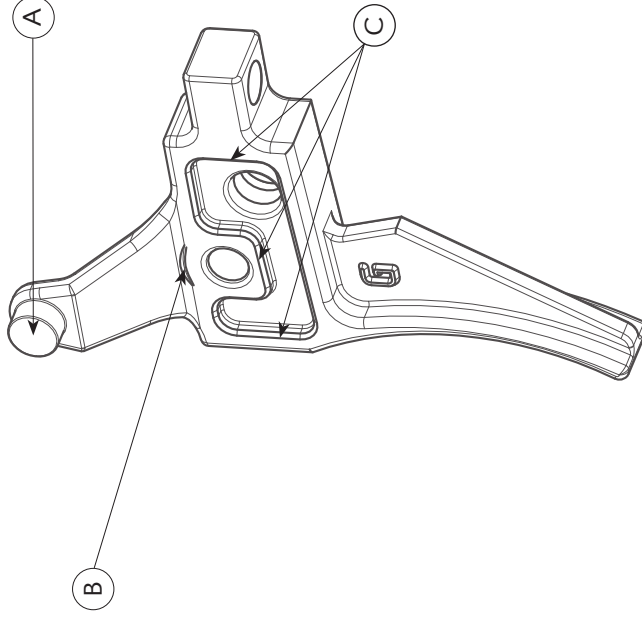

PHYSICAL PROPERTIES	
SU	
SY	
EL	
RA	
BH	
RH	
BASE	
NONE	

UNLESS OTHERWISE SPECIFIED DIMENSIONS ARE IN INCHES	
ANGLES: 1.0	DECIMALS: 0.x .020
FRACTIONS: 1/32	0.xx .010
	0.xxx .003
MATERIAL	
HEAT TREATMENT	
FINAL PROTECTIVE FINISH	

ORIGINAL DATE OF DRAWING	2/19/2015
DRAFTSMAN	NPM 2/19/15
ENGINEER	WHG
APPROVED	WHG
UNIT VOLUME	
UNIT WEIGHT	

**GEISSELE AUTOMATICS LLC**  
800 NORTH WALES ROAD, NORTH WALES, PA 19454

**LIGHTNING BOW FOR IWI TAVOR**

REV	A	DWG NO	05-328
SCALE		SHEET	1 OF 1

**THIS DRAWING IS PROPRIETARY AND CONFIDENTIAL**

THIS DRAWING HAS COPYRIGHT WHICH IS OWNED BY GEISSELE AUTOMATICS. NEITHER THIS DRAWING ITSELF NOR ARTICLE NOR COMPONENT ILLUSTRATED THEREIN MAY BE REPRODUCED IN WHOLE OR IN PART, IN ANY FORM, WITHOUT THE WRITTEN PERMISSION OF GEISSELE AUTOMATICS. THIS DRAWING HAS BEEN PREPARED FROM THE BEST AVAILABLE INFORMATION AND IS NOT TO BE USED IN ANY WAY AGAINST THE INTERESTS OF GEISSELE AUTOMATICS AND WILL BE RETURNED ON DEMAND.